

[SSO Microsoft] Como cadastrar A2F

Sistemas

| Sistema | Link |
|---------|------|
| | |

Como configurar conta Microsoft

1. Acessar o Link :

<https://aka.ms/mfasetup>

2. Logar com as credenciais que deseja alterar seguindo todos os passos

3. Clicar em **Add sign-in method**

My Sign-Ins

Overview

Security info

Devices

Password

Organizations

Settings & Privacy

Recent activity

Security info

These are the methods you use to sign into your account or reset your password.

You're using the most advisable sign-in method where it applies.
Sign-in method when most advisable is unavailable: Phone - text +55 41996506432 [Change](#)

+ Add sign-in method

| | | | | |
|--|---|---|------------------------|------------------------|
| | Alternate phone | +55 41999105790 | Change | Delete |
| | Phone | +55 41996506432 | Change | Delete |
| | Password | Last updated: 6 days ago | Change | |
| | App password | Senha inicial de aplicativo20220316073930 | | Delete |
| | Authenticator app Time-based one-time password (TOTP) | | | Delete |
| | Microsoft Authenticator Push multi-factor authentication (MFA) | 21061110AG | | Delete |

4. Escolher **authenticator app**

Change

Delete

Add a method

Which method would you like to add?

Choose a method

Authenticator app

App password

Office phone

5. Clicar em **add**

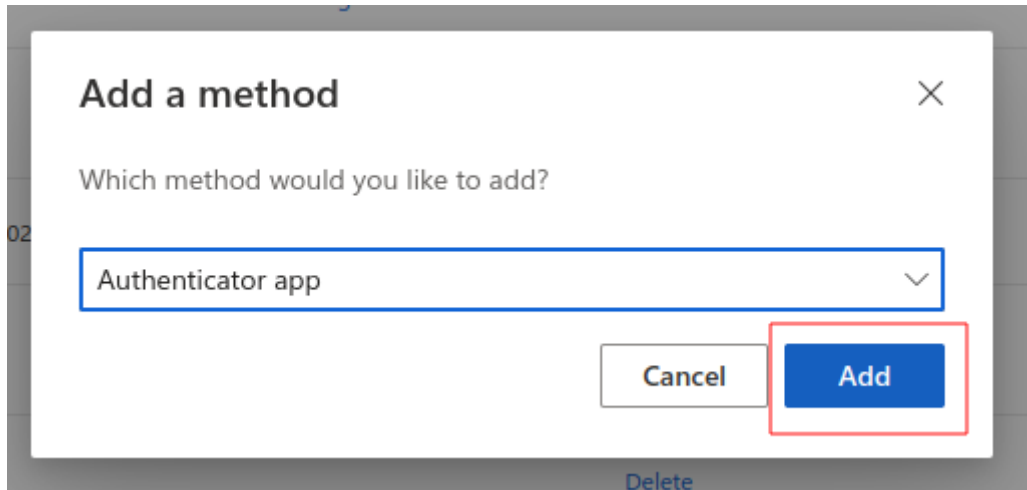

Add a method X

Which method would you like to add?

Authenticator app

Cancel Add

Delete

6. Clicar em **I want to use a different authenticator app**

Verifique se o botão "Quero usar outro aplicativo autenticador" aparece na página. Se esse botão **não** estiver visível, **não será possível** usar o Google Authenticator para configurar

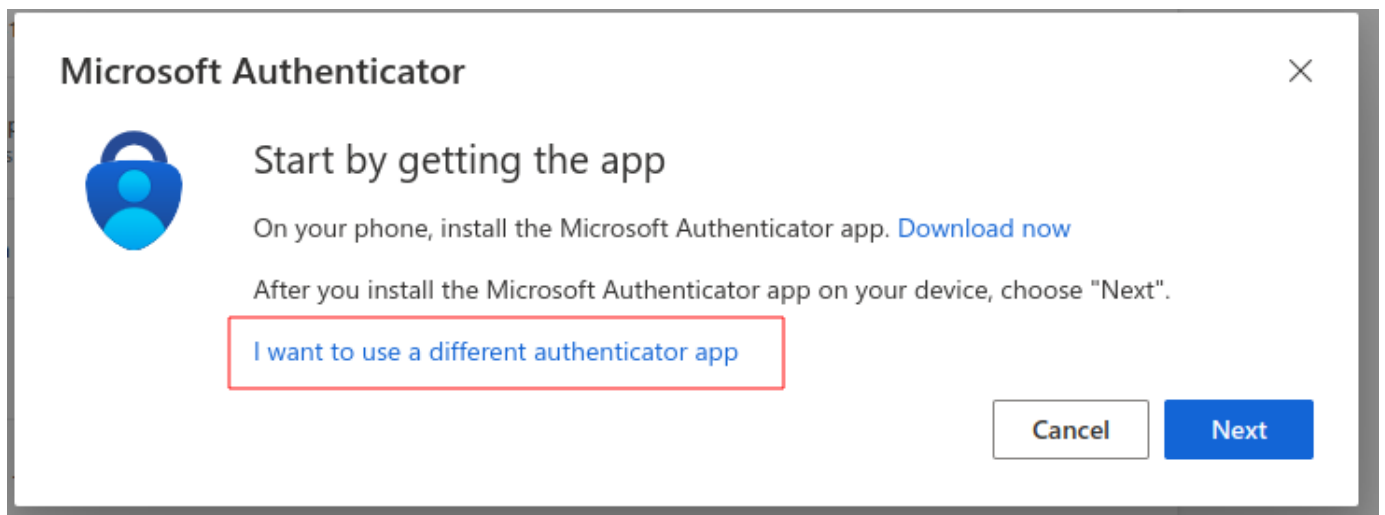

Microsoft Authenticator X



Start by getting the app

On your phone, install the Microsoft Authenticator app. [Download now](#)

After you install the Microsoft Authenticator app on your device, choose "Next".

[I want to use a different authenticator app](#)

Cancel Next

7. Clicar em **Next**

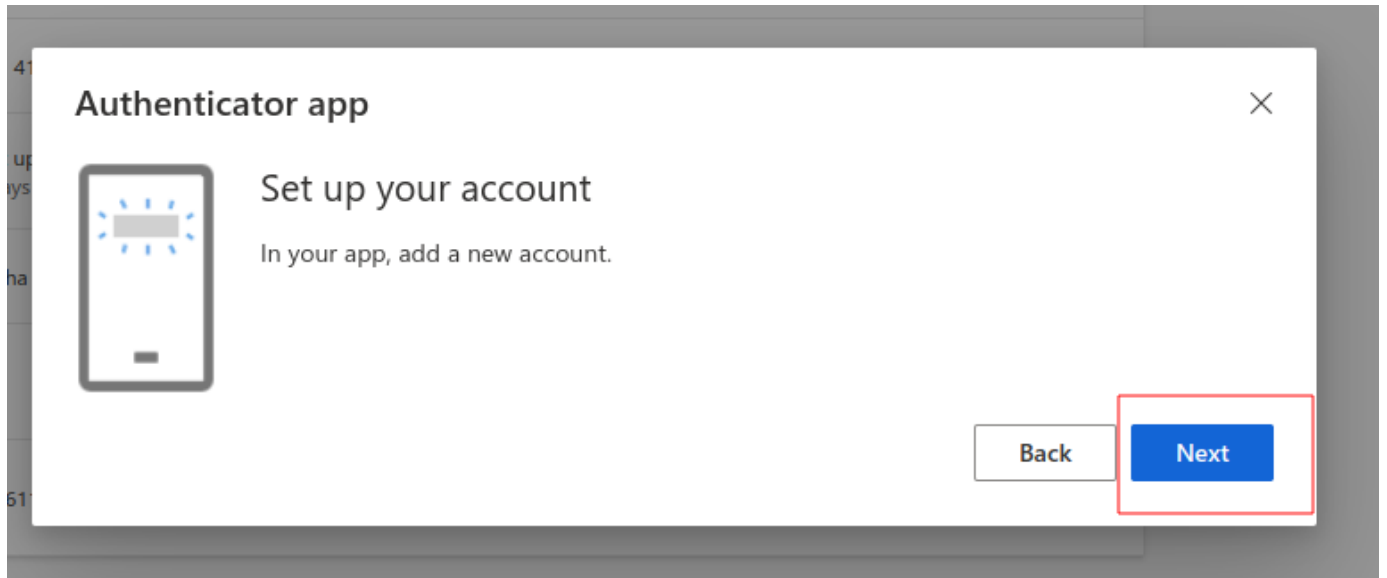

8. Escanear o **QR Code** ou seguir para o passo 9

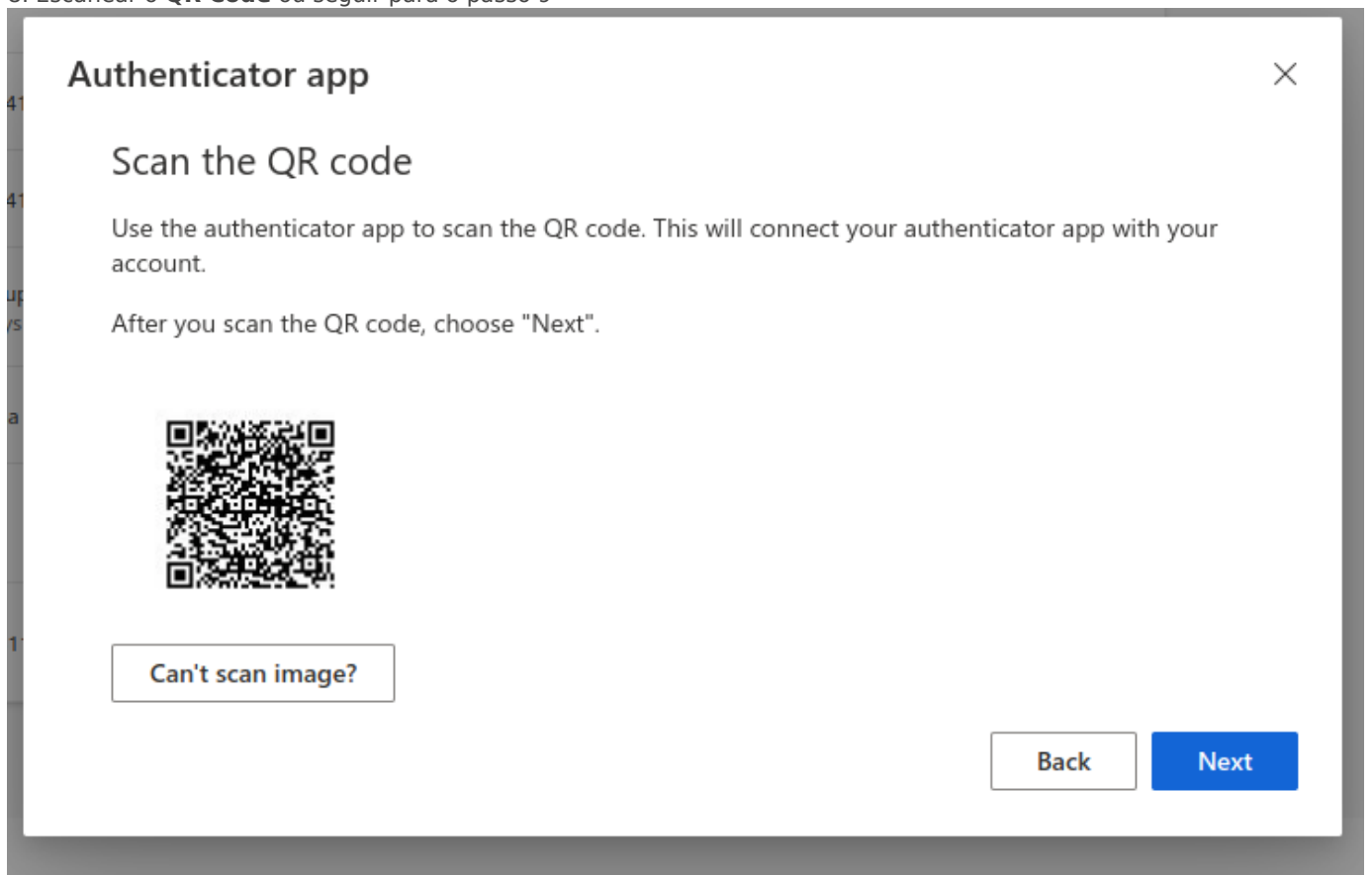

9. Copiar a chave **Secret Key**

- Adicione esse código no console Oystr ([Console Oystr](#)); e
- Adicione esse código no aplicativo google authenticator ([Google Authenticator](#))

it applies

32

41

41

jp

es

a

1

Authenticator app

×

Scan the QR code

Use the authenticator app to scan the QR code. This will connect your authenticator app with your account.

After you scan the QR code, choose "Next".



Can't scan image?

Enter the following into your app:

Account name: Embracon Administradora De Consórcios Ltda:freitas.andreia@embracon.com.br



Secret key: snvy5n7vplxthyzn



Back

Next

10. Cadastrar a chave no authenticador do Google e no painel da Oystr

11. Pegar um código gerado pelo painel da Oystre ou pelo aplicativo do Google para validar a autenticação.

PASSO IMPORTANTE

Delete

Authenticator app

XXX XXX

Enter code

Enter the 6-digit code shown in the Authenticator app.

Enter code

Back

Next

Guarde a chave para quando precisar adicionar em outro sistema ou outra integração

Revision #9

Created 2 July 2024 11:38:15 by Luan Melo

Updated 23 August 2024 20:02:07 by Luan Melo